

ABRC Presentation/Activity Schedule, Thursday, 12 January 2017
Grand Ballroom C, Galveston Island Convention Center

* Student paper competitor

Time	Author(s)	Speaker Affiliation	Title
7:15 – 8:00am	Conference Registration		
8:00 – 8:10am	Welcome Remarks, Dr. Elina Niño, President of AAPA., Dr. Mike Simone-Finstrom, Vice-President of AAPA and ABRC Program Organizer		
8:10am–9:00am	Dr. Jeff Pettis Keynote Speaker	Institute of Bee Health University of Bern, Switzerland	""
9:00am-9:12am	Andrea Wade* , Reed Johnson	Department of Entomology The Ohio State University, Wooster, OH	"Combined toxicity of chlorantraniliprole and propiconazole due to P450 inhibition in honey bees "
9:12am–9:24am	Adrian Fisher II* , Juliana Rangel	Department of Entomology Texas A&M University, College Station, TX	" The negative effects of in-hive pesticides on honey bee (<i>Apis mellifera</i>) drone sperm viability "
9:24am–9:36am	Elizabeth M Walsh* , Juliana Rangel	Department of Entomology, Texas A&M University, College Station, TX	"The effects of pesticides on honey bee (<i>Apis mellifera</i>) queen reproductive physiology and behavior "
9:36am–9:48am	Mehmet Ali Doke* , Christina M Grozinger	Department of Entomology, The Center for Pollinator Research, The Pennsylvania State University	"Pheromonal control of overwintering in honey bee colonies "
9:48am–10:00am	Rodney T. Richardson* , Megan Ballinger, Feng Qian, John Christman, Reed Johnson	Department of Entomology The Ohio State University, Wooster, OH	"Morphological and functional characterization of honey bee hemocytes "
10:00am–10:12am	Alexandria Payne* , Juliana Rangel	Department of Entomology Texas A&M University, College Station, TX	"The effects of honey bee (<i>Apis mellifera</i>) queen insemination volume on colony growth "
10:15am–10:30am	Morning break, refreshments		
10:30am–10:42am	Cameron Jack* , Jamie Ellis	Department of Entomology and Nematology University of Florida, Gainesville, FL	" The efficacy of artificial brood interruption and oxalic acid in controlling the honey bee pest <i>Varroa destructor</i> "
10:42am–10:54am	Kelly Kulhanek* , N. Steinhauer, D. Reynolds, R. Fahey, A. Nearman, Dennis vanEngelsdorp	Department of Entomology University of Maryland, College Park	"The sentinel apiary program: Collaborating with beekeepers to improve colony health and management"
10:54am–11:06am	Meghan E. McConnell* , Dennis vanEngelsdorp	Department of Entomology University of Maryland, College Park	"Mechanical disturbance as a non-chemical control of varroa mites in honey bee colonies"
11:06am–11:18am	Nathalie Steinhauer* , M.E. Wilson, C. Saegerman, D. vanEngelsdorp	Department of Entomology University of Maryland, College Park	"Expert-based best management practices for US beekeepers"
11:18am–11:30am	Natalia Riusech*	Department of Entomology The Ohio State University, Wooster, OH	"Factors that influence treatment practices used by beekeepers to control for Varroa mites"
11:30am–11:45am	Samuel D. Ramsey* , Dennis vanEngelsdorp	Department of Entomology University of Maryland, College Park	" <i>Varroa destructor</i> feed primarily on honey bee fat body not hemolymph "
11:45am-1:00pm	Lunch break (on your own)		

Time	Author(s)	Speaker Affiliation	Title
1:00pm–1:12pm	Kirsten S. Traynor, J.S. Pettis, D.R. Tarpy, C.A. Mullin, J.L. Frazier, M. Frazier, D. vanEngelsdorp	Department of Entomology University of Maryland, College Park	"Re-evaluating pesticide risk by mode of action"
1:12pm–1:24pm	Geoff Williams	Department of Entomology & Plant Pathology Auburn University	"Do neonicotinoid pesticides serve as inadvertent insect contraceptives? Effects on male honey bees"
1:24pm–1:36pm	William Meikle	USDA-Agricultural Research Service Tucson, AZ	"Can we measure colony-level effects in cages? Monitoring effects of sublethal neonicotinoid exposure"
1:36pm–1:48pm	Kristen Healy, J. Ottea, T. Walker, F. Rinkevich, J. Margotta, V. Pokhrel, R. Vaeth, C. Hoffman, B. Fritz, R. Danka	Department of Entomology Louisiana State University	"Evaluating the effects of mosquito control adulticides on honey bees"
1:48pm–2:00pm	Frank Rinkevich, Robert Danka, Kristen Healy	USDA-Agricultural Research Service Baton Rouge, LA	"Influence of <i>Varroa destructor</i> infestation levels and management practices on insecticide sensitivity in the honey bee (<i>Apis mellifera</i>)"
2:00pm–2:12pm	Andony Melathopoulos, Ramesh Sagili	Department of Horticulture Oregon State University	"Pollinator protection in Oregon: Getting beyond best management practices?"
2:12pm–2:24pm	Bernardo D. Niño, Patricia Bohls, Elina L. Niño	Department of Entomology University of California, Davis	"Efficacy of novel bio-pesticides on varroa mites in honey bee colonies"
2:24pm–2:36pm	Richard E.L. Rogers	Bee Care Center Bayer Crop Sciences	"The Healthy Colony Checklist: A system to quickly assess, record, understand, and plan management of honey bee colony health"
2:36pm–2:48pm	Rassol Bahreini, Medhat Nasr	Alberta Agriculture and Forestry	"Evaluation of synthetic miticides efficacy in Varroa mites control"
2:48pm–3:00pm	Brandon K. Hopkins, Walter S. Sheppard	Department of Entomology Washington State University	"Overwintering strategies and their effects on honey bee nutrition"
3:00–3:30pm	Afternoon break, refreshments sponsored at the NABC break		
3:30pm–3:42pm	Megan J. Colwell*, Robert W. Currie, and Stephen F. Pernal	Department of Entomology University of Manitoba, Canada	"Viruses in unexpected places: new transmission routes of European honey bee (<i>Apis mellifera</i>) viruses"
3:42pm–3:54pm	Laura M. Brutscher*, Michelle Flenniken	Plant Sciences and Plant Pathology Montana State University	"Honey Bee Transcriptional Response to Virus Infection"
3:54pm–4:06pm	Courtney MacInnis*, B.A. Keddie, S.F. Pernal	University of Alberta Agriculture and Agri-Food Canada	" <i>Nosema ceranae</i> : A sweet surprise? Investigating the viability and infectivity of <i>N. ceranae</i> spores"
4:06pm–4:18pm	Morgan K. Carr-Markell*, R.S. Cornman, D. Iwanowicz, M. Spivak	Department of Entomology University of Minnesota, Twin Cities	"Do honey bees near reconstructed prairies collect significant amounts of food from native prairie flowers?"
4:18pm–4:30pm	Cora M. Demler*, M.K. Carr-Markell, M. Couvillon, R. Schuerch, M. Spivak	Department of Entomology University of Minnesota, Twin Cities	"Determining relative attractiveness of reconstructed native prairies to honey bee foragers"
4:30pm–4:42pm	Pierre Lau*, J. Rangel, V. Bryant, D. Schmehl, J. Sullivan, Z. Huang, J. Ellis, A. Cabrera	Department of Entomology Texas A&M University, College Station, TX	"Palynological analysis of pollen collected by honey bees (<i>Apis mellifera</i>) in developed areas in four regions of the United States"
4:42pm–4:54pm	James Wolfin*, Ian Lane, M. Spivak	Department of Entomology University of Minnesota, Twin Cities	"Enhancing turf lawns to benefit honey bees and other pollinators"

5:00pm–6:30pm NC1173 Business meeting (separate agenda), located in the Grand Ballroom C

Dinner (on your own)

6:30pm-8:00pm

Poster Session and Social
Sponsored by Veto-pharma

Located in the Conferee Lounge (San Luis Hotel & Conference Center, 2nd floor)

Posters

Hailey Curtis, R. Richardson, C.-H. Lin, R. Johnson	Department of Entomology The Ohio State University, Wooster, OH	"Molecular investigation of honey bee foraging on soybean, Glycine max, in Ohio, USA"
Joseph Cazier	Center for Analytics Research and Education Appalachian State University, Boone, NC	"Data standardization: The first step to building an intelligent hive management system"
Maxcy P. Nolan IV, Keith S. Delaplane	Department of Entomology University of Georgia	"Dispersal risk tolerance is mediated by reproductive value in <i>Varroa destructor</i> "
Lilia I. de Guzman, Amanda M. Frake, Michael Simone-Finstrom	USDA-Agricultural Research Service Baton Rouge, LA	"Comparative flight activities of varroa-infested and uninfested bees using RFID technology"
David De Jong, Aline Patty Turcatto, Joyce Mayra Volpini de Almeida, Elisa Cimitan Mendes	Genetics Department University of São Paulo, Brazil	"Honey bees in Brazil do not require treatment for <i>Varroa</i> infestations"
Alejandra N. Gonzalez Rojas, Juliana Rangel Posada	Department of Entomology Texas A&M University, College Station, TX	"Antioxidative enzymes expression in honey bee (<i>Apis mellifera</i>) queens as an assessment of reproductive quality"
Shelley Hoover	Alberta Agriculture and Forestry	"Pollen collection, honey production, and paid pollination services"
Robert Heyduck, Melanie Kirby, Todd Bates	Department of Plant and Environmental Sciences New Mexico State University	"Assessing <i>Monarada fistulosa</i> var. <i>menthifolia</i> for possible honeybee health and habitat enhancement"
Jianghong Li, Wenfeng Li, Yahzou Zhou, Jay D Evans, Yanping Chen	USDA-ARS, Beltsville, MD College of Bee Science Fujian Agriculture and Forestry University, China	"The new evidence that gut microbes comprehensively regulate honeybee immunity"
Martin A. Matisoff, Susan Kivikko, Steve Kivikko, Thomas C. Webster	College of Agriculture Kentucky State University	"Teaching the teachers: A hands-on approach to learning honey bee anatomy and pathology"
Andrée Rousseau, Pierre Giovenazzo	Centre de recherche en sciences animales de Deschambault	"Optimizing drone fertility with nutritional supplements to honey bee colonies during spring"
Sreelakshmi Suresh, Chia-Hua Lin, Emma Matcham, Douglas Sponsler, Reed Johnson	Department of Entomology The Ohio State University, Wooster, OH	"Soybean as a major Nectar Source for Honey Bees"
Kaira Wagoner, Olav Rueppell	Department of Biology University of North Carolina at Greensboro	"Hygienic response to natural and synthetic brood chemicals associated with common honey bee stressors"
Meng Yue, Shudong Luo	Institute of Apicultural Research Chinese Academy of Agricultural Sciences	" <i>Apis cerana</i> is less sensitive to most pesticides, despite of their smaller size"

ABRC Presentation/Activity Schedule, Friday, 13 January 2017
Grand Ballroom C, Galveston Island Convention Center

Time	Author(s)	Speaker Affiliation	Title
8:00 – 8:10am	Announcements and Student Award Winners		
8:10am–9:00am	Dr. Steve Pernal Keynote Speaker	Agriculture and Agri-Food Canada	"Progress in marker-assisted selection for honey bee breeding"
9:00am-9:12am	B. Emsen, P. Unger, L.G. Espinoza-Montano, T. Petukhova, M.M. Hamiduzzaman, G.J. Hunt, Ernesto Guzman-Novoa	School of Environmental Sciences University of Guelph	"Intensity of grooming behavior and resistance to <i>Varroa</i> in honey bees"
9:12am–9:24am	Nicolas Derome, Stephen F. Pernal, Pierre Giovenazzo	Département de biologie Université Laval, Quebec	"BeeProbio: Sustaining honeybee health with probiotics"
9:24am–9:36am	Christina Mogren , Jim Ottea, and Kristen Healy	Department of Entomology Louisiana State University	"Sublethal effects associated with supplemental feeding and other stressors in honey bees"
9:36am–9:48am	Xianbing Xie, Shudong Luo, Zachary Y. Huang	Department of Entomology Michigan State University	"Cost of relocating honey bee colonies"
9:48am–10:00am	Carlos Castillo	National Bee Diagnostic Centre Beaverlodge, Alberta, Canada	"Canadian National Honey Bee Health Survey"
10:00am–10:12am	Renata S. Borba , K. Baylis, M. Bixby, R. Currie, N. Derome, V. Fournier, P. Giovenazzo, M. Guarna, S. Hoover, S. Pernal, A. Zayed, L.J. Foster	University of British Columbia Agriculture and Agri-Food Canada	"Sustaining and securing Canada's honey bees using 'omics approaches"
10:15am–10:30am	Morning break, refreshments		
10:30am–10:42am	David A. Galbraith , D. Annoscia, E.L. Niño, F. Nazzi, X. Yang, S.V. Yi, V. Zanni, C.M. Grozinger	Department of Entomology, The Center for Pollinator Research, The Pennsylvania State University	"Genomic analyses of viruses in global bee populations"
10:42am–10:54am	Daniel R. Schmehl , Kim Huntzinger, and Dick Rogers	Bayer Crop Science	"The temporal and spatial distribution of the honey bee pest <i>Nosema spp.</i> in the United States"
10:54am–11:06am	Esmail Amiri , Gregory Seddon, Wendy Zuluaga Patricio, Micheline Strand, David Tarpy, Olav Rueppell	Department of Biology University of North Carolina at Greensboro	"Israeli acute bee paralysis virus and the health of honey bee queens"
11:06am–11:18am	Martine Bernier , Julie Arseneault, Pierre-Luc Mercier, Pierre Giovenazzo	Centre de recherche en sciences animales de Deschambault	"Detection of small hive beetle in naturally infested hives via DNA analysis of hive debris and scraps"
11:18am–11:30am	Ramesh Sagili , Cameron Jack, Hannah Lucas, Tom Webster, Sai Sree Uppala	Department of Horticulture Oregon State University	"New insights into <i>Nosema ceranae</i> infection: Colony level infection dynamics and effects of pollen nutrition"
11:30am–11:42am	Wenfeng Li , J.D. Evans, Q. Huang, C. Rodriguez-García, J. Liu, M. Hamilton, C.M. Grozinger, Thomas Webster, S. Suf, Y.P. Chen	USDA-Agricultural Research Service Beltsville, MD	"RNA interference (RNAi) as a novel treatment for <i>Nosema ceranae</i> infection in European honey bees <i>Apis mellifera</i> "
11:42am–11:54am	Rob Currie , Graham Parsons, Zoe Rempel	Department of Entomology University of Manitoba, Canada	"Manipulating varroa mite and virus levels on a colony scale to quantify their impact on colony winter survival"
12:00-1:30pm	Lunch break AAPA Business meeting (catered lunch for AAPA members that RSVP'd. All AAPA welcome). Schooner Room 1st floor, Convention Center.		

Time	Author(s)	Speaker Affiliation	Title
1:30pm–1:42pm	Reed M. Johnson, Andrea Wade, Bridget Gross, Ashley Cordle and Chia-Hua Lin	Department of Entomology The Ohio State University, Wooster, OH	“Effect of pesticide combinations applied to almonds during bloom on honey bee workers and queens”
1:42pm–1:54pm	Brian D. Eitzer, Kimberly A. Stoner and Richard S. Cowles	Connecticut Agricultural Experiment Station	“Evaluating the risk pesticide use at ornamental nurseries pose to honey bees”
1:54pm–2:06pm	Stephanie Darnell	Bayer Crop Science	“Detection of imidacloprid residues in pollen and nectar collected from annual and perennial bedding plants purchased from selected retail garden stores”
2:06pm–2:18pm	Allen W. Olmstead	Bayer Crop Science	“The chronic toxicity of clothianidin supplied via nectar substitute to honey bee colonies ”
2:18pm–2:30pm	Mark J. Carroll, Nicholas Brown, and Zachary Ruetz	USDA-Agricultural Research Service Tucson, AZ	“Effects of imidacloprid-contaminated sugar stores on overwintering honey bee colonies”
2:30pm–2:42pm	Georges Martin, Pierre Giovenazzo	Centre de recherche en sciences animales de Deschambault	“Feeding strategies to shift honey bee foraging behavior during cranberry pollination and the impact on colony development”
2:42pm–2:54pm	Margaret J. Couvillon	Department of Entomology Virginia Tech	“Environmental Consultancy: dancing bees bioindicate the landscape’s profitability for pollinators”
2:54pm–3:06pm	Roger Schuerch	Department of Entomology Virginia Tech	“Noisy dancers: information and individuality in honey bee waggle dance communications”
3:10–3:30pm	Afternoon break, refreshments sponsored at the NABC break		
3:30pm–3:42pm	Steve Cook	USDA-Agricultural Research Service Beltsville, MD	“The energetics of phoretic and foundress Varroa mites”
3:42pm–3:54pm	Stephanie Gage, Catherine Kramer, Samantha Calle, Mark Carroll, Michael Heien, Gloria DeGrandi-Hoffman	USDA-Agricultural Research Service Tucson, AZ	“Beyond the Gut: <i>Nosema</i> parasitism in honey bees impacts neurochemistry and olfactory learning and memory”
3:54pm–4:06pm	Margarita M. Lopez-Urbe, Michael Simone-Finstrom	Department of Entomology, The Pennsylvania State University	“Glucose oxidase production after colony infection: Testing its role in honey bee social immunity ”
4:06pm–4:18pm	Rong Ma, Gabriel Villar, Christina M. Grozinger, Juliana Rangel	Department of Integrative Biology University of Texas at Austin	“Behavioral and molecular mechanisms of pheromone transmission in honey bees (<i>Apis mellifera</i>)”
4:18pm–4:30pm	Elina L. Niño, W. Cameron Jasper, Christina M. Grozinger	Department of Entomology University of California, Davis	“New insights into seminal fluid regulation of post-mating changes in honey bee queens”
4:30pm–4:42pm	Marta Guarna, Katie Joselow, Jeffery Pettis, Steve Pernal	Agriculture and Agri-food Canada	“Exposing queens to high temperature affects their performance”
4:42pm–4:54pm	Greg J. Hunt, Miguel Arechavaleta-Velasco, Joshua Given, Jennifer Tsuruda, Miguel Arechavaleta-Velasco	Department of Entomology Purdue University	“An update on parental effects on aggression and gene expression in African-European hybrid honey bees”
5:00pm–5:30pm	AIA / AAPA / CAPA Panel Discussion		
5:30pm	Conference Adjourned. Safe travels!		

Area and Conference Center(s) Guide

THE SAN LUIS RESORT SPA & CONFERENCE CENTER

- 1 Galveston Island Convention Center of The San Luis Resort
- 2 Hilton Galveston Island Resort
- 3 Landry's Seafood
- 4 Rainforest Cafe & River Adventure Ride
- 5 IHOP Restaurant
- 6 Grotto Ristorante
- 7 The Seaside
- 8 The San Luis Hotel, Spa & Conference Center
- 9 The Villas at The San Luis Resort
- 10 Holiday Inn Resort Galveston - on the Beach

IMAGINE yourself on an ISLAND GETAWAY



Poster Session and Social (Thursday)

GALVESTON ISLAND CONVENTION CENTER AT THE SAN LUIS RESORT

LEVEL ONE
★ **AAPA Lunch (Friday)**



LEVEL TWO

★ **Conference**

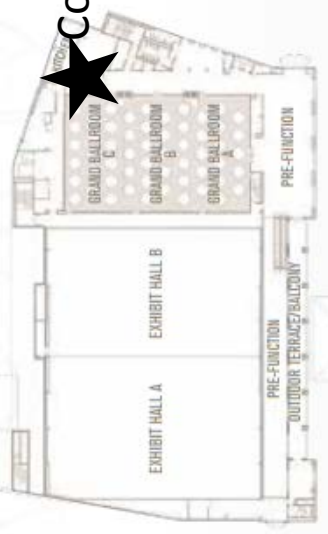

THE SAN LUIS HOTEL SPA & CONFERENCE CENTER CONFERENCE CENTER - Second Floor

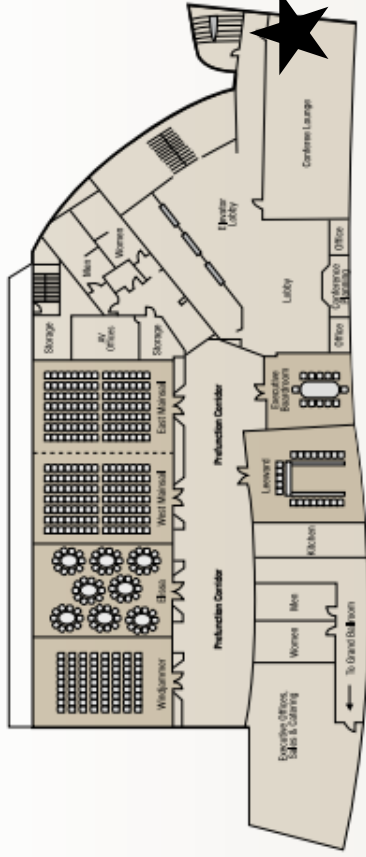

★ **Poster Session and Social (Thursday 6:30-8pm)**